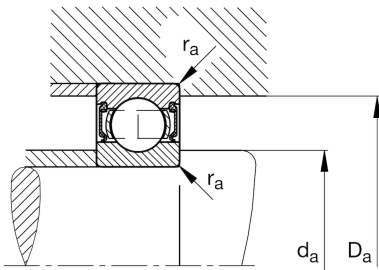
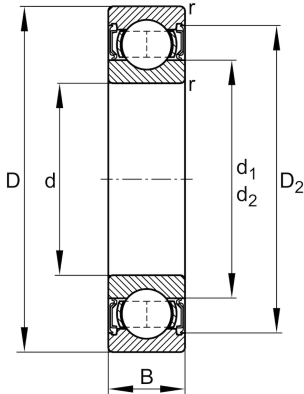

**FAG****6201-2RSR**

Deep groove ball bearing

Deep groove ball bearing 62...-2RSR, single row, seals, steel sheet metal cage

Technical information

**Main Dimensions & Performance Data**

d	12 mm	Bore diameter
D	32 mm	Outside diameter
B	10 mm	Width
C_r	7.300 N	Basic dynamic load rating, radial
C_{0r}	3.100 N	Basic static load rating, radial
C_{ur}	203 N	Fatigue load limit, radial
n_G	14.600 1/min	Limiting speed
$\approx m$	0,035 kg	Weight

Mounting dimensions

$d_{a \min}$	16,2 mm	Minimum diameter shaft shoulder
$D_{a \max}$	27,8 mm	Maximum diameter of housing shoulder
$r_{a \max}$	0,6 mm	Maximum fillet radius

Dimensions

r_{\min}	0,6 mm	Minimum chamfer dimension
D_1	25,88 mm	Shoulder diameter outer ring
D_2	27,35 mm	Caliber diameter outer ring
d_1	18,3 mm	Shoulder diameter inner ring

Temperature range

T_{\min}	-20 °C	Operating temperature min.
T_{\max}	100 °C	Operating temperature max.

Calculation factors

f_0	12,3	Calculation factor
-------	------	--------------------